

Powell, Daniel (VDH)

From: Powell, Daniel (VDH)
Sent: Tuesday, February 13, 2018 4:09 PM
Subject: Shoreline Survey # 003 "Potomac River: Mattox Creek to Currioman Bay" - Westmoreland County

The updated shoreline survey for Growing Area # 003 "Potomac River: Mattox Creek to Currioman Bay" found in Westmoreland County is now available at...

<http://www.vdh.virginia.gov/content/uploads/sites/20/2016/05/survey003.pdf>

Daniel Powell, GISP

Classification Assistant/GIS Analyst

VDH | Division of Shellfish Sanitation | 109 Governor St | Richmond, VA 23219

804.864.7482 | daniel.powell@vdh.virginia.gov | www.vdh.virginia.gov/shellfish

CONFIDENTIALITY NOTE: The information contained in this transmission may be privileged and confidential information, and is intended only for the use of the individual or entity named above. If you have received this transmission in error, please immediately reply to the sender that you have received this communication in error and then delete it. Thank you.

will@littleneck.com; chad@ballardfish.com; allen.knapp@vdh.virginia.gov; jennifer.palmore@deq.virginia.gov; shellfish_whitestone@vdh.virginia.gov; jbateman@nnpdc17.state.va.us; vlent.lassiter@deq.virginia.gov; david.fridley@vdh.virginia.gov; herman@vims.edu; jeremy.kazio@deq.virginia.gov; nrisavi@westmoreland-county.org; preston.smith@vdh.virginia.gov; robert.connell@fda.hhs.gov; curtis.linderman@deq.virginia.gov; shellfish_central@vdh.virginia.gov; bob.mauskapf@vdh.virginia.gov; patricia.duttry@vdh.virginia.gov; amy.robins@deq.virginia.gov; elizabeth.anderson@vdh.virginia.gov; tim@clamandoyster.com; anne.schlegel@deq.virginia.gov; timr@clamandoyster.com; ajerskine@bevansoyster.com; tnolley@oysterva.com; amy.walker@dcr.virginia.gov; lance.gregory@vdh.virginia.gov; kim@littleneck.com



COMMONWEALTH of VIRGINIA
DEPARTMENT OF HEALTH
DIVISION OF SHELLFISH SANITATION

Marizza J. Levine, MD, MPH, FAAFP
State Health Commissioner

109 Governor Street, 6th Floor
P.O. Box 2448
Richmond, Virginia 23218

Ph: 804-864-7487
Fax: 804-864-7481

POTOMAC RIVER: MATTOX CREEK TO CURRIOMAN BAY
Growing Area # 003
Westmoreland County
Shoreline Sanitary Survey

Date: 3 February 2018

Survey Period: November 13, 2017 - January 19, 2018

Total Number of Properties Surveyed: 40

Surveyed By: R.M. Thomas, W.A. McCarty III, & W. I. Barrack III

Section A: GENERAL

This survey area extends from Reference Point 3 at Church Point to Reference Point 4 at Nomini Cliffs, including the Potomac River shoreline between these two points, Bridges Creek, Digwood Swamp, Popes Creek, Popes Creek Swamp, Big Meadow Run, Little Meadow Run and all of their tributaries (within the designated boundary line drawn by the Division of Shellfish Sanitation).

The topography of the area varies in elevations from 10' or less along the shoreline to a maximum of 150' inland. The economy is based primarily on retail trade, professional/ technical services and construction. The population is mostly sparse with moderate concentrations in the various residential subdivisions along the shoreline. The US Census Bureau reported that the population of Westmoreland County showed a 1 percent increase between 2009 and 2017. Two historic sites, George Washington's birthplace and Stratford Hall Plantation (birthplace of Robert E. Lee), are located within the boundary line. Also located in this survey area is Westmoreland State Park. Cabins at Stratford Hall and Westmoreland State Park offer overnight lodging. Additional information about Westmoreland County can be found on the county website at: www.co.westmoreland.va.us.

Meteorological data indicated that the area received a total rainfall of 3.91" for the survey period. A monthly breakdown is as follows:

Nov 13-30, 2017	0.71"	December	0.92"	Jan 1-19, 2018	2.28"
-----------------	-------	----------	-------	----------------	-------

At the beginning of the survey, inspectors reviewed the available literature from prior reports, public works and online resources to characterize land use, drainage patterns, and established nearshore seawater stations. Properties identified in the previous survey as having sanitary deficiencies or other environmental significance were revisited to evaluate their current status. All roadways and navigable shoreline within the survey boundary were visually inspected to identify potential pollution sources requiring further investigation.

Nearshore seawater stations were established to survey the full extent of waters beyond routine classification stations. Stations were created in closer proximity to the shoreline and farther upstream than routine stations and are intended to evaluate drainage entry points of potential pollution sources. Station data were analyzed to compare relative concentrations of fecal indicator bacteria within the waterway to identify potential onshore sources of contamination. Areas with elevated concentrations of fecal indicator bacteria were surveyed onshore using a property by property approach. Surveyors interviewed occupants and examined properties for evidence of pollution sources within the immediate watershed.

Hydrographic data and sampling times are shown in the table below. Maps of the enterococcus sampling are shown at the conclusion of this report.

Area 3 Nearshore Sampling					Rainfall in Inches		
Sample dates	Run #	High Tide	Ebb Current	Sampling time	Day of	Previous 24 hours	Previous 72 hours
12/7/17	SS	8:44 am	11:32 am – 4:38	11:43-2:16	0.00	0.08	0.01
12/15/17	PC	3:49 am	6:14 am – 11:48	9:41-11:37	0.00	0.00	0.00
12/20/17	PC	7:41 am	10:22 am – 3:09	10:33-12:51	0.00	0.00	0.00
1/16/18	PC	5:51 am	8:22 am – 1:24	9:53-12:11	0.00	0.00	0.00

Copies of Bacteriological and Shellfish Closure data are available at the area office for review. This report lists only those properties that have a sanitary deficiency or other environmental significance. “**DIRECT**” indicates that the significant activity or deficiency has a direct impact on shellfish waters. Data in this report are also made available to local health departments and other agencies to address items that may be out of compliance with their regulatory programs. Copies of VPDES Permits and inspections are available at the Department of Environmental Quality, Tidewater Regional Office (DEQ/TRO).

Copies of the current condemnation notices and maps are available via the Internet at www.vdh.virginia.gov/shellfish/.

SUMMARY

Growing Area # 003
Potomac River: Mattox Creek to Currioman Bay
3 February 2018

SECTION B: SEWAGE POLLUTION SOURCES

1. SEWAGE TREATMENT FACILITIES

- 0 – DIRECT – None
- 0 – INDIRECT – None
- 0 – B.1. TOTAL

2. ON-SITE SEWAGE DEFICIENCIES – Correction of the deficiencies in this section is the responsibility of the local health department.

- 0 – CONTRIBUTES POLLUTION, DIRECT – None
- 1 – CONTRIBUTES POLLUTION, INDIRECT – # W10
- 0 – CP (Kitchen or Laundry Wastes), DIRECT – None
- 0 – CP (Kitchen or Laundry Wastes), INDIRECT – None
- 0 – NO FACILITIES, DIRECT – None
- 0 – NO FACILITIES, INDIRECT – None
- 1 – B.2 TOTAL

3. POTENTIAL POLLUTION – Periodic surveillance of these properties will be maintained to determine any status change.

- 0 – POTENTIAL POLLUTION – None

SECTION C: NON-SEWAGE WASTE SITES

1. INDUSTRIAL WASTE SITES

- 0 – DIRECT – None
- 0 – INDIRECT – None
- 0 – C.1. TOTAL

2. SOLID WASTE SITES

- 0 – DIRECT – None
- 0 – INDIRECT – None
- 0 – C.2. TOTAL

SECTION D: BOATING ACTIVITY

- 0 – MARINAS – None
- 1 – OTHER PLACES WHERE BOATS ARE MOORED – # W2
- 4 – UNDER SURVEILLANCE – # W1, W3, W4, W5
- 5 – D. TOTAL

SECTION E: CONTRIBUTES ANIMAL POLLUTION

- 1 – DIRECT – # W6
- 3 – INDIRECT – # W7, W8, W9
- 4 – E. TOTAL

SECTION F: STORMWATER OUTFALLS

- 1 – DIRECT – # W11
- 0 – INDIRECT – None
- 1 – E. TOTAL

Virginia Department of Health
Division of Shellfish Sanitation

Potomac River:
Mattox Creek to Currioman Bay
003
Shoreline Sanitary Survey

Westmoreland County

Date: 3 February 2018
Survey By: R.M. Thomas, W.A. McCarty,
& W.I. Barrack
Number of Properties Surveyed: 40

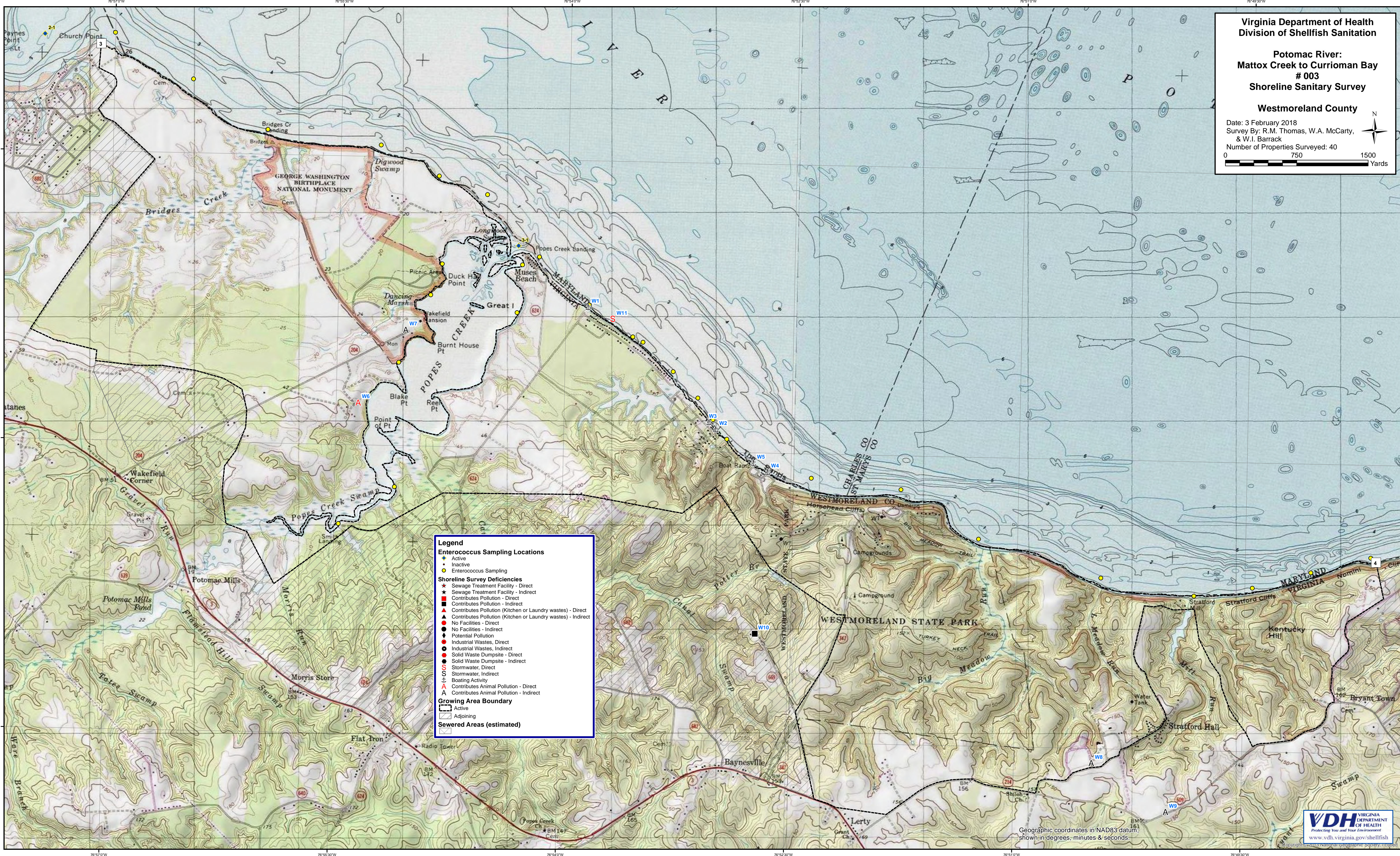
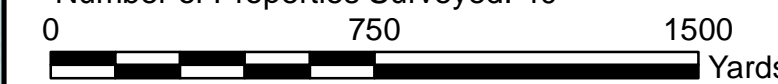

Legend

Enterococcus Sampling Locations

- Active
- Inactive
- Enterococcus Sampling

Shoreline Survey Deficiencies

- ★ Sewage Treatment Facility - Direct
- ★ Sewage Treatment Facility - Indirect
- Contributes Pollution - Direct
- Contributes Pollution - Indirect
- ▲ Contributes Pollution (Kitchen or Laundry wastes) - Direct
- ▲ Contributes Pollution (Kitchen or Laundry wastes) - Indirect
- No Facilities - Direct
- No Facilities - Indirect
- Potential Pollution
- Industrial Wastes, Direct
- Industrial Wastes, Indirect
- Solid Waste Dumpsite - Direct
- Solid Waste Dumpsite - Indirect
- S Stormwater, Direct
- S Stormwater, Indirect
- ⚓ Boating Activity
- A Contributes Animal Pollution - Direct
- A Contributes Animal Pollution - Indirect

Growing Area Boundary

- Active
- Adjoining

Sewered Areas (estimated)

- ▨

Geographic coordinates in NAD83 datum:
shown in degrees, minutes & seconds.

